

Soils Map

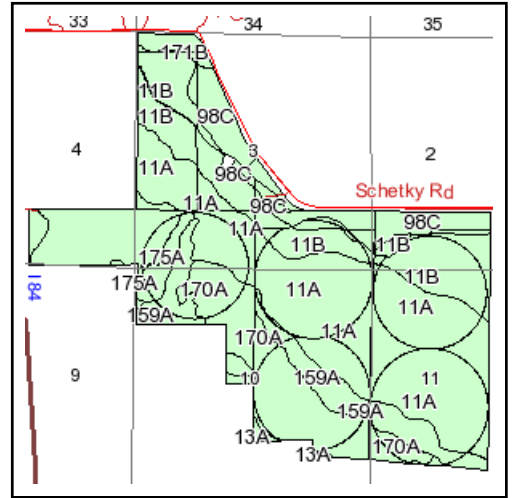

State: **Oregon**
 County: **Baker**
 Location: **010-008S-040E**
 Township: **Baker City**
 Acres: **1127.4**
 Date: **4/29/2011**

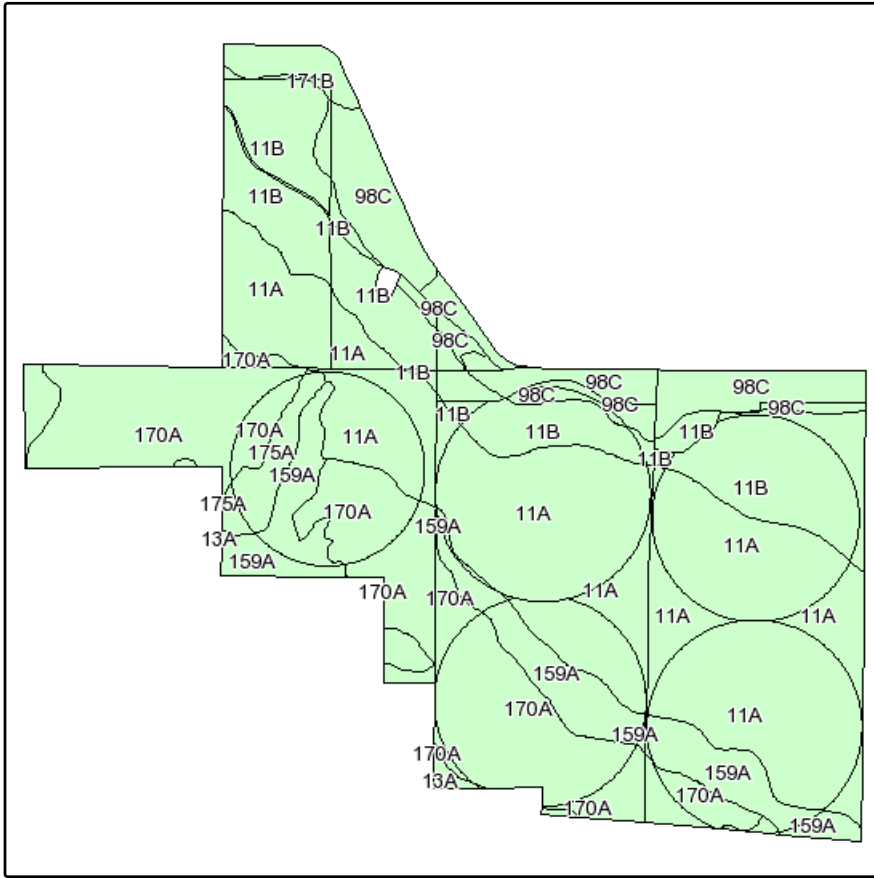

Maps provided by:



©AgriData, Inc 2008
www.AgriDataInc.com

Fsa borders provided by the Farm Service Agency as of May 23, 2008.
Soils data provided by USDA and NRCS.

Code	Soil Description	Acres	Percent of field	Non-Irr Class	Irr Class	Grass legume hay Irrigated	Alfalfa hay Irrigated	Barley Irrigated	Pasture Irrigated	Pasture	Winter wheat Irrigated	Winter wheat	Grass legume hay	Grass hay Irrigated	C si Ir
11A	Baker silt loam, 0 to 2 percent slopes	423.1	37.5%	IVs	III s	4	7	84	10		80	25			
170A	Umapine silt loam, 0 to 2 percent slopes	247.8	22.0%	IVw											
11B	Baker silt loam, 2 to 7 percent slopes	201.1	17.8%	IVe	III e	4	6	84	10		80	25			
98C	Lookout silt loam, 2 to 12 percent slopes	105.8	9.4%	VIe											
159A	Stanflow-Umapine silt loams, 0 to 2 percent slopes	101.8	9.0%	IVw	IV s			40	6	1					
175A	Wingdale silt loam, 0 to 2 percent slopes	19.2	1.7%	III w	III w			40	8						3
171B	Virtue silt loam, 2 to 7 percent slopes	15.4	1.4%	VIe	III e	4	5	85	10	1	80				
62A	Haines silt loam, 0 to 2 percent slopes	9.2	0.8%	IVw				40	7						
13A	Baldock silt loam, 0 to 2 percent slopes	4	0.4%	IVw	III w	4		40	8	4			2		
Weighted Average						2.3	3.8	52.4	6.4	0.1	45.4	13.8	0	0.1	