

Range 23 Township 09 Section 25

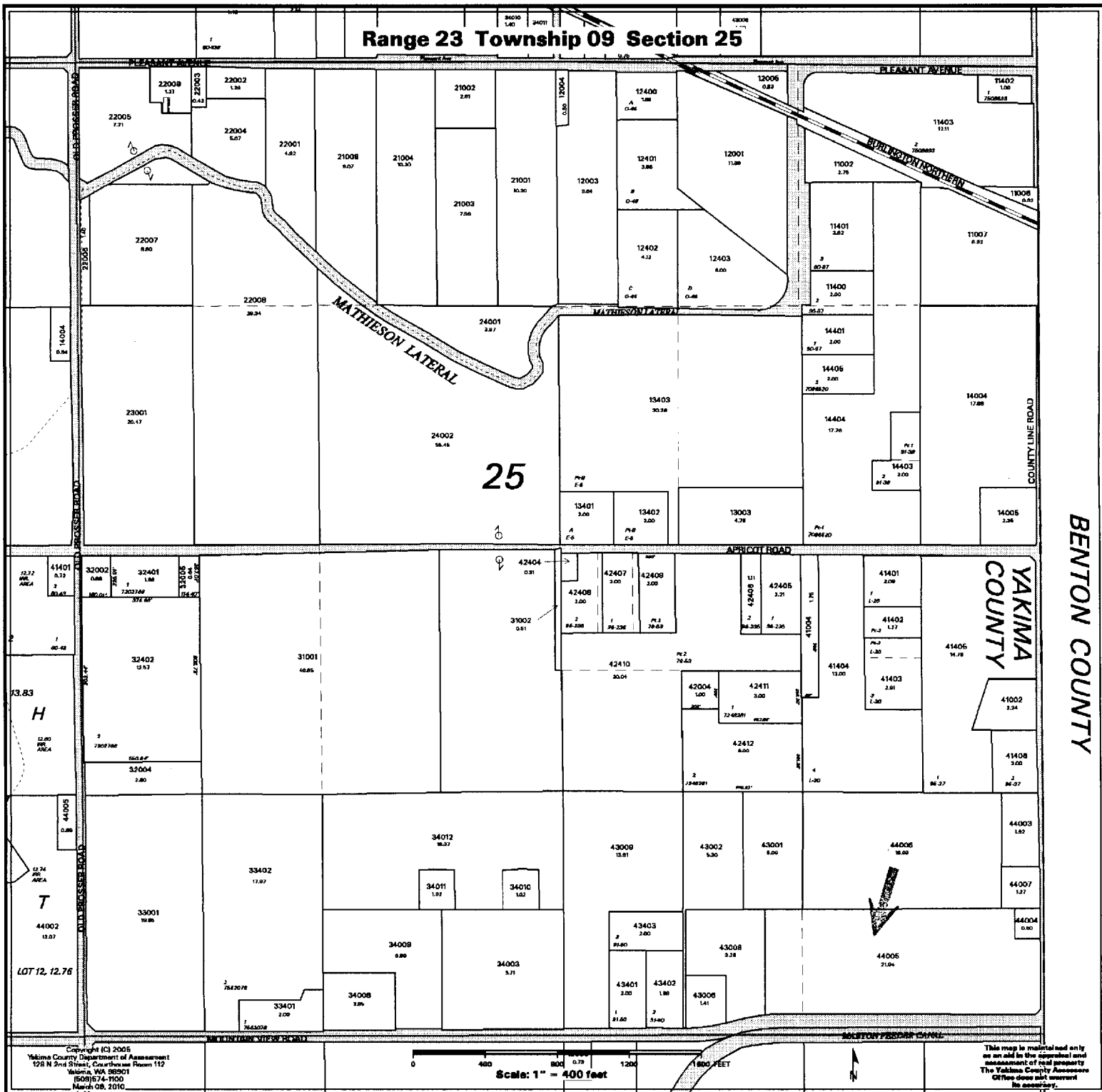

Copyright (C) 2005
 Yakima County Department of Assessment
 128 N 2nd Street, Courthouse Room 112
 Yakima, WA 98901
 (509) 674-7100
 March 08, 2010

0 400 800 1200 1600 FEET
 Scale: 1" = 400 feet

This map is material only
 as an aid in the appraisal and
 assessment of real property.
 The Yakima County Assessor's
 Office does not warrant
 its accuracy.